

State Well Report

Part 1 - Driller's Log

Mississippi Department of Environmental Quality
Office of Land and Water Resources
P.O. Box 2309
Jackson, MS 39225
(601)961-5210
(601)961-5228 (fax)

County: Desoto
Permit #: GW-45013
Driller: Delta Drilling of Tunisia
Date drilling completed: 9-15-11

For Office Use Only:
Aquifer: _____
Well #: E 139
L. S. Elevation: _____
E-log #: _____

State Law requires that this report be prepared by the license holder responsible for the work and filed with the Department at the above address within 30 days of completion of drilling of the well or borehole.

| Information on Well Owner (Landowner if borehole is not for a water well) | Well or Borehole Location |
|--|---|
| Owner Name: <u>Bobby Leatherman</u> | Latitude: <u>N 34° 53' 30"</u> Longitude: <u>90° 11' 52"</u> |
| Mailing Address: <u>Leatherman Family Partnership</u> <u>3364 Poplar Ave.</u> | Method of Lat/Long (circle one): Conventional Survey |
| <u>Memphis</u> <u>Tn.</u> <u>38111</u> | USGS quad, <u>Hand-held GPS</u> , Survey-grade GPS |
| City State Zip Code | <u>NW 1/4 NW 1/4 Sec 30</u> <input checked="" type="checkbox"/> <u>Twn 2S</u> <input checked="" type="checkbox"/> <u>Rng 9W</u> <input checked="" type="checkbox"/> |
| Telephone No. () _____ | Distance Direction Nearest Town <u>2</u> Miles <u>South</u> of <u>Lake Cormorant, Ms.</u> |

Well / Borehole Data

Date drilling started: 9-15-11 Date drilling completed: 9-15-11 Hole depth: 105 Hole diameter: 24"

Location of the source of any surface water used for drilling: Fire Hydrant 2 miles East
Method of dosing and volume of Chlorine used in drilling and development: _____

Logs run (circle all applicable): No log run Electric Gamma Ray Density Sonic Neutron Other: _____
Name of organization running log(s): _____

Purpose of borehole (check one): Water Well Geotechnical/Geological Investigation _____ Ground Source Heat Pump _____
Seismic Survey _____ Other (describe) _____

If drilling is not related to water well construction, skip the remainder of this block

Purpose of Well (check one): Home _____ Industrial _____ Public Supply _____ Irrigation Fish Culture _____ Other: _____

If a flowing well, method of flow regulation: Valve _____ Other (describe) _____

Static Water Level: 20 feet above or below (circle one) land surface Date measured: 9-16-11

Method of Measurement (circle one) steel tape electric tape air line other: _____

Well depth: 105 Well grouted to a depth of 10 feet Type of grout (circle one): Neat Cement Bentonite Mix

Casing length: 65 feet Casing diameter: 16 inches Type of casing: PVC

Screen length: 40 feet Screen diameter: 16 inches Type of screen: PVC

Screen slot size: .032 inches Setting depth: From 65 feet to 105 feet

Type of completion (circle all applicable): Gravel packed Underreamed Telescoped Open hole Natural Development
Other (describe): _____

Top of lap pipe or reduction in casing: _____ feet. ***If telescoped or more than one screen, describe on next page***

Form: OLWR-SWR-1A (04/08)

RECEIVED

SEP 21 2011

BY: OLWR

The sketch below only required for water wells

Description of formations encountered must be provided for all wells and boreholes, unless specifically exempted by regulations

If well telescopes, show depths on sketch.

Ground Level →

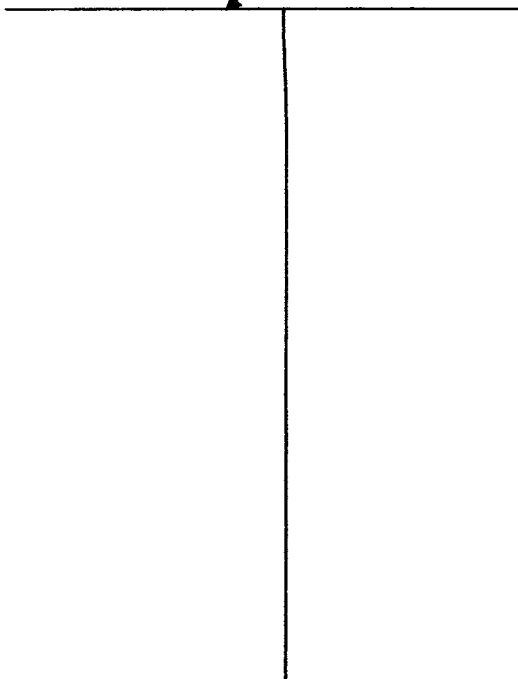

| Description of Formations Encountered | From (depth) | To (depth) |
|---------------------------------------|--------------|------------|
| loamy sand | Ground Level | 21 |
| clay | 22 | 40 |
| coarse sand & gravel | 41 | 105 |
| | | |
| | | |
| | | |
| | | |
| | | |
| | | |
| | | |
| | | |
| | | |
| | | |
| | | |
| | | |
| | | |
| | | |
| | | |
| | | |
| | | |

If more than one screen, show location of each on sketch

Sketch the property layout and include the following: 1) the well location; 2) any permanent structures on the property that may aid in locating the well; 3) any roads, power lines, or other items that may aid in locating the property and the well; 4) a north arrow.

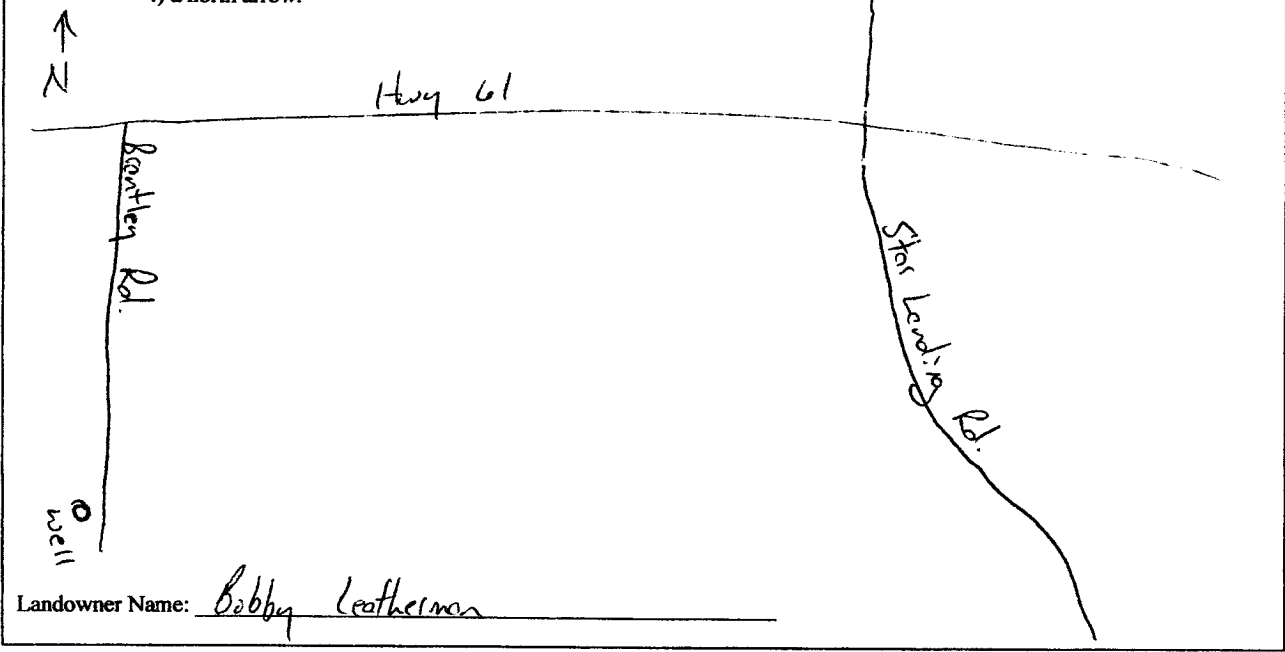

Form: OLWR-SWR-1A (04/08)

I certify that the well/borehole was drilled, constructed, and completed in accordance with all applicable requirements of the Mississippi Department of Environmental Quality and the Mississippi Department of Health regulations, if applicable, and state laws.

Chris Shockley # 2561 10-16-11
Print Name of Responsible Licensee and License No. Date

[Signature]
Signature of Licensee

RECEIVED
DEC 01 2011
BY: OLWR

STATE WELL REPORT

Part 2

Pump Installer's Completion Report
 Mississippi Department of Environmental Quality
 Office of Land and Water Resources
 P.O. Box 2309
 Jackson, MS 39225
 (601)961-5210
 (601)961-5228 (fax)

County: DeSoto
 Permit #: GW-45613
 Driller: Delta Drilling of Tunica
 Date completed: 9-16-11
Copy information from block on Part 1

For Office Use Only:

Aquifer: _____
 Well #: E139
 Elevation: _____

This part of the report must be completed by a licensed water well contractor or a licensed pump installer. A copy of Part 1 of the report must be attached and both parts filed with the Department at the above address within 30 days of well completion.

| Well Owner Information | Well Location |
|--|--|
| Owner Name: <u>Bobby Leatherman</u> | Latitude: <u>N 31° 53.580'</u> Longitude: <u>W 90° 11.873'</u> |
| Mailing Address: <u>Leatherman Family Partnership</u> <u>3364 Poplar Ave.</u> | Method of Lat/Long (check one): Conventional Survey _____ USGS quad _____, Hand-held GPS <input checked="" type="checkbox"/> , Survey-grade GPS _____ |
| <u>Memphis</u> <u>Tn.</u> <u>3811</u> City State Zip Code | <u>NW 1/4 NW 1/4 Sec 30 T 2S R 9W</u> |
| Telephone No. () _____ | Distance Direction Nearest Town <u>2.0 Miles SE of Lake Cormorant, Ms.</u> |

| Pump Type Circle one | Power Type Circle one |
|---|---|
| Air Lift Jet Submersible | Diesel Engine Gasoline Engine Natural Gas |
| Bucket Piston <u>Turbine</u> | <u>Electric Motor</u> Hand Tractor PTO |
| Centrifugal Rotary Flowing Well | Windmill Other (specify): _____ |
| Other (specify): _____ | Horse Power Rating of Motor: <u>60</u> |
| Date Pump Installed: <u>9-16-11</u> | Setting Depth: <u>60</u> feet |
| Rated Pump Capacity: <u>2500</u> Gallons Per Minute | Number of Stages: <u>2</u> |

| Pump Test Data | Method of Measuring Water Level Circle one |
|--|---|
| Date Well Tested: _____ | Air Line Electric Measuring Line <u>Steel Tape</u> |
| Static Water Level (A): _____ Feet Below Land Surface | Other (specify): _____ |
| Pumping Water Level (B): _____ Feet Below Land Surface | For flowing well, measured shut in head: _____ feet |
| Drawdown [(B) - (A)]: _____ Feet Below Land Surface | Well yielded _____ GPM with a drawdown of _____ feet after _____ hours of pumping |
| Test Pumping Rate: _____ Gallons Per Minute | |
| Duration of Pump Test (minimum 4 hours): _____ hours | |

I HEREBY CERTIFY that the above statements are true to the best of my knowledge.

Chris Shockley # 2561
 Print Name of Pump Installer and License No. (if applicable)

[Signature]
 Signature of Pump Installer

RECEIVED
 Form: OLWR-SWR-1B (04/08)
 DEC 01 2011
 BY: OLWR